

## 1. Features

1. This specification applies Low Profile Power Inductors.
2. 100% Lead(Pb) & Halogen-Free and RoHS compliant.
3. Operating Temperature:-40~+125°C (Including self-temperature rise)

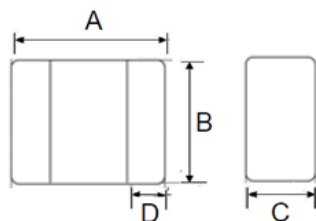

## 2. Dimensions



Size	A(mm)	B(mm)	C(mm)	D(mm)
252010	2.5±0.2	2.0±0.2	1.0 max	0.5±0.2

### Recommended PC Board Pattern

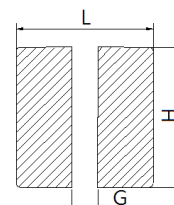

L(mm)	G(mm)	H(mm)
2.8	1.2	2.3

## 3. Part Numbering

**AWP** **252010** **FW** - **2R2** **M**

A: Series  
 B: Dimension  
 C: Material  
 D: Inductance  
 E: Inductance Tolerance

Flat wire  
 2R2=2.20uH  
 M=±20%

## 4. Specification

TAI-TECH Part Number	Inductance (uH)	Test Frequency (Hz)	I rms (A)		I sat (A)		DCR (mΩ)	
			typ.	max.	typ.	max.	typ.	max.
AWP252010FW-R24M	0.24±20%	1M/1V	5.7	5.0	6.3	5.6	18	22
AWP252010FW-R36M	0.36±20%	1M/1V	4.7	4.3	4.9	4.5	23	28
AWP252010FW-R47M	0.47±20%	1M/1V	4.4	4.0	4.5	4.2	28	34
AWP252010FW-R68M	0.68±20%	1M/1V	4.2	3.6	4.3	3.8	34	41
AWP252010FW-R82M	0.82±20%	1M/1V	3.8	3.3	4.0	3.5	40	48
AWP252010FW-1R0M	1.00±20%	1M/1V	3.4	3.0	3.7	3.35	52	62
AWP252010FW-1R5M	1.50±20%	1M/1V	2.6	2.2	2.9	2.6	82	98
AWP252010FW-2R2M	2.20±20%	1M/1V	2.2	1.8	2.3	1.9	105	126
AWP252010FW-3R3M	3.30±20%	1M/1V	2.0	1.6	2.1	1.7	130	156

Note:

1. Isat : Saturation Current (Isat) will cause L0 to drop approximately 30%.
2. Irms : Heat Rated Current (Irms) will cause the coil temperature rise approximately ΔT of 40°C.
3. Rated DC Current : The less value which is Irms or Isat.

### 5. Typical Performance Curves

