

Wire Wound Type Common Mode Filter

WCM2012F2SF-SERIES-G

1. Features

1. High common mode impedance at high frequency cause excellent noise suppression performance.
2. WCM2012F2SF series realizes small size and low profile. 2.0x1.2x1.2 mm.
3. 100% Lead(Pb) & Halogen-Free and RoHS compliant.
4. Operating temperature -40~+125°C (Including self - temperature rise)
5. FOR LAN Module application.



2. Dimension

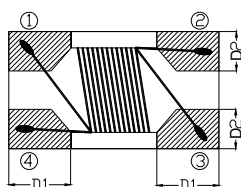
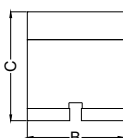
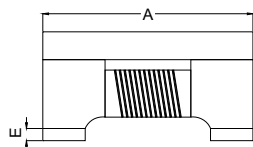

Series	A(mm)	B(mm)	C(mm)	D1(mm)	D2(mm)	E(mm)
2012F2SF	2.0±0.2	1.2±0.2	1.2±0.2	0.50±0.1	0.51±0.1	0.15±0.1

3. Part Numbering

WCM	2012	F	2	S	F	-	900	T	04	-	G
A	B	C	D	E	F		G	H	I		J

- A: Series
 B: Dimension
 C: Material Ferrite Core
 D: Number of Lines 2=2 lines
 E: Type S=Shielded , N=Unshielded
 F: Lead free
 G: Impedance 900=90Ω
 H: Packaging T=Taping and Reel
 I: Rated Current 04=400mA
 J: Control S/N

4. Specification

TAI-TECH Part Number	Common mode Impedance (Ω)	Test Frequency (MHz)	DC Resistance (Ω) max.	Rated Current (mA)max.	Rated Volt. (Vdc)max.	Withstand Volt. (Vdc) max.	IR (Ω) min.
WCM2012F2SF-900T04-G	90±25%	100	0.30	400	50	125	10M
WCM2012F2SF-801-G	800±25%	100	0.88	300	50	125	10M

5. Schematic Diagram

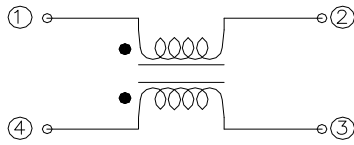

Typical Impedance v.s. Frequency Curve

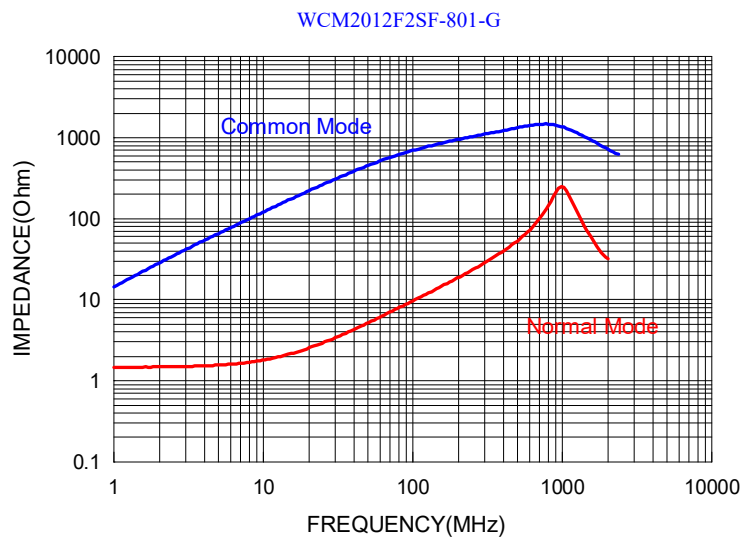
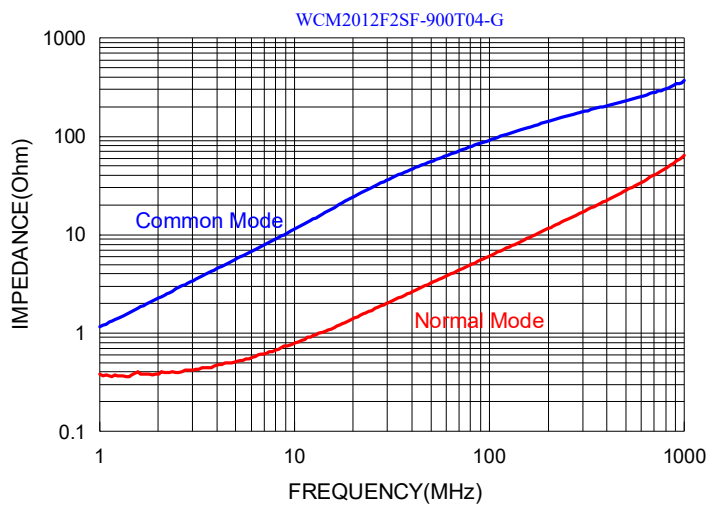

Insertion loss

WCM2012F2SF-900T04-G

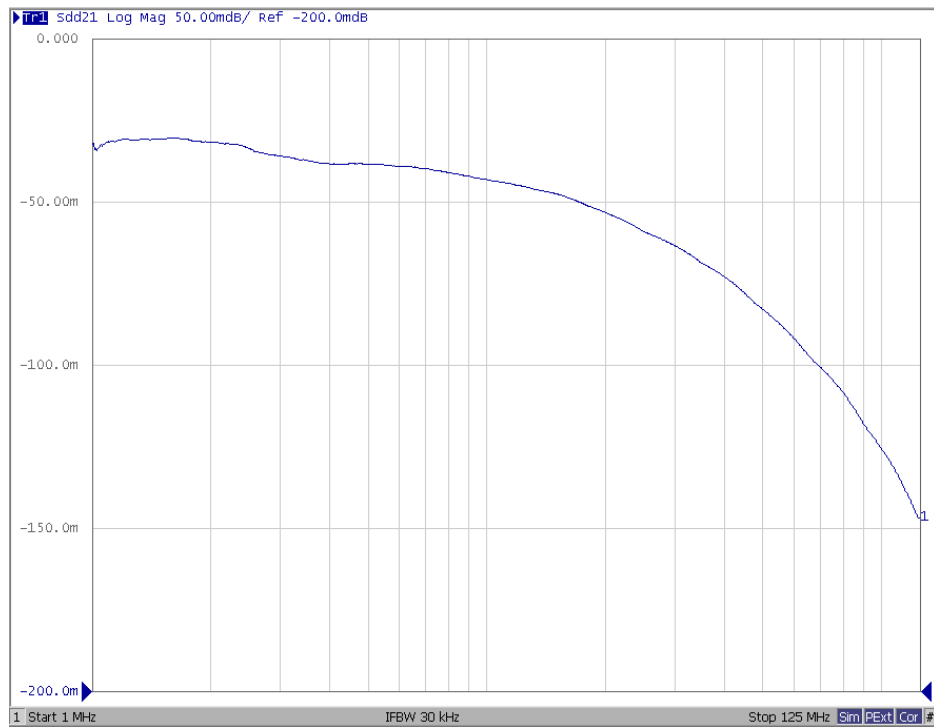

WCM2012F2SF-801-G

